

Notes:
 All dimensions are to be checked and confirmed prior to the commencement of works and prior to the commencement of works on site.
 Materials, workmanship & construction are to conform with the relevant standards, Codes of Practice, Approved Documents & any other relevant documents, recommended specifications and are to fully comply with the Building Regulation, related approved documents and legislation.
 All services are to be installed in accordance with statutory authority regulations and by-laws.
SAFETY:
 All Builder practices are to comply with:
 • The Health & Safety at Work Act (1974)
 • The Management of Health and Safety at Work Regulations (1999)
 • The Construction (Health & Safety Welfare) Regs. (1988)
 • The Construction (Lifting Operations) Regs. (1981)
 • The Construction (Head Protection) Regs. (1989)
 • The Construction (Design & Management) Regs. (2007)
 • COSHH Regs
 • PUWER Regs
 • Lifting Operations Regs
 • Manual Handling Regs
 Go to www.hse.gov.uk for further information.

| | | | |
|------------------------|--------------|-------|------|
| ID | Project | Ref's | DATE |
| REV | DESCRIPTION | | |
| CHG | Mr. S. Jones | | |
| Additional information | | | |

Shows
 Proposed change of use from residential flat to additional bar and storage area for bar / retail facility at No 41, High Street, Clydach

| | | |
|------------|-------------|-------|
| Scale (A3) | Drawing No. | Issue |
| As shown | SJ-010 | 00 |

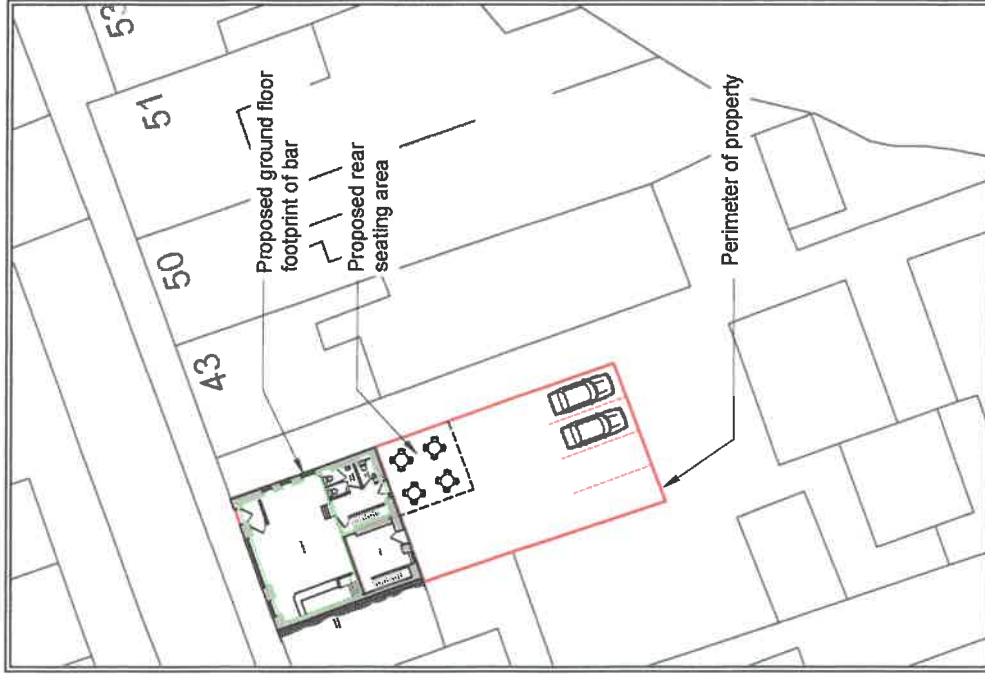

Block plan
 Scale - 1:500

WARNING: THIS MAY BE A REDUCED SIZE PRINT, CHECK SCALE BELOW

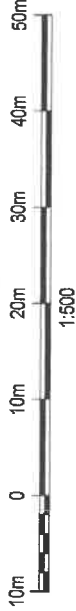

Key:
 Mixed retail / bar
 Licenseable area

Consumable area

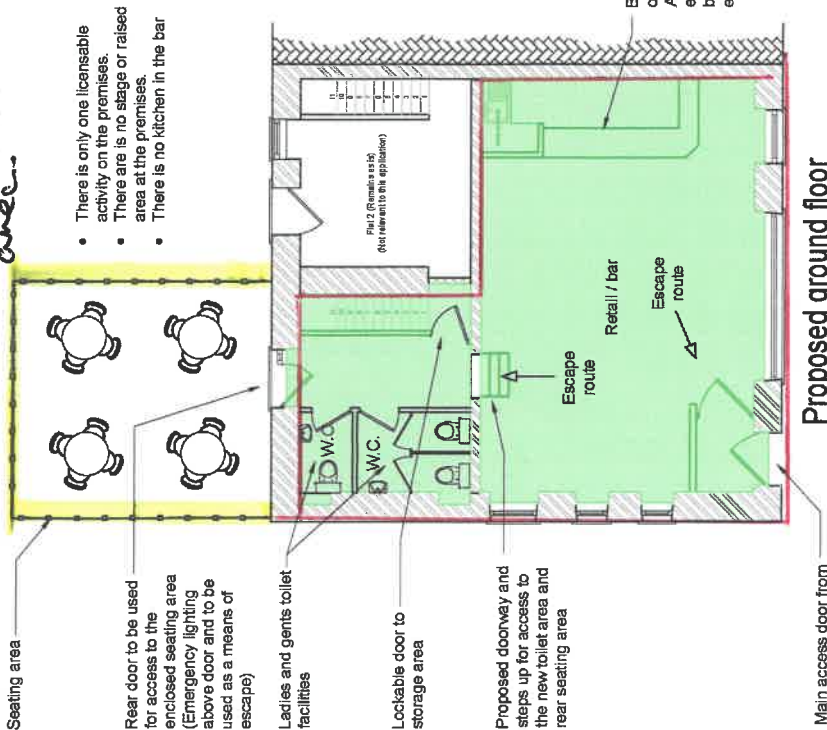

Proposed ground floor
 Scale - 1:100

WARNING: THIS MAY BE A REDUCED SIZE PRINT, CHECK SCALE BELOW

